



MARITEAM

- YACHTING -



Grand Banks 42 Classic 'Charlotte'

LOA (m):	13.17 m
Beam (m):	4.29 m
Draft (m):	1.27 m
Engines:	2x 210hp Caterpillar
Cabins:	2
Homeport:	Mariteam Yachting
Price:	€ (not set)

Grand Banks 42 Classic 'Charlotte' from 2002 with hull number 1493.

'Charlotte' is in perfect condition and has very desirable options, such as: stabilizers, two Caterpillar 210 hp, proportional hydraulic bow thruster, double radar and air conditioning throughout the ship.

MARITEAM YACHTING

De Draei 29, 8621 CZ Heeg 📍 The Netherlands 📞 Phone +31 (0) 582 889254
info@mariteamyachting.nl 🌐 www.mariteamyachting.nl

Main specifications

Model:	42 Classic
LOA (m):	13.17 m
Beam (m):	4.29 m
Draft (m):	1.27 m
Year:	2002
Hull Material:	GRP
Cabins:	2
Sleeping places:	4
Number of main engine(s):	2
Power of main engine(s) (hp):	210
Brand of main engine(s):	Caterpillar
Price:	€ (not set)
VAT status:	Paid
HIN number:	MS-GNDD1493L102

General

Name :	Charlotte
Shipyard:	Grand Banks
CE-category:	A
Cruising speed (Kn):	9
Air draft (m):	4.34
Displacement (t):	18
Fuel tank (Litre and material):	2271 steel
Freshwater Tank (Liter and material):	1014 aluminium
Black water tank (Litre and material):	105 plastic
Hull material:	GRP

Superstructure material:	GRP
Deck material:	GRP
Deck finish:	Teak
Interior finish:	Teak
Window material:	Single
Antifouling (Year):	2017

Accommodation

Cabins:	2x
Double bed:	1x
Single berths:	2x
Showers:	2x
Toilets:	2x Sealand type-K
Heating system (brand, model, type):	Marine air systems
Airconditioning system (Brand, model):	Marine air systems
Stove:	2x Gaggenau hlvg232 2x Gaggenau hlvc230
Microwave:	Gaggenau em-203-130/01
Refrigerator:	Coolmatic Mdc 110
Washing machine/Dryer:	Brandt a class

Machinery

Port engine (Brand, type, hp, gearbox):	Caterpillar/ 3208/ 210/ Twin disc MG 5061-A
Engine hours port engine:	1485
Star engine (Brand, type, hp, gearbox):	Caterpillar/ 3208/ 210/ Twin disc MG 5061-A
Engine hours starboard engine:	1485

Steering system:	Hydraulisch
Drive (Shaft, IPS, Jet):	Shaft
Shaft lubrication:	Duramax marine
Prop (Number of blades, material):	4, brons
Generator (Brand, type, Kw):	Onan MDKAL 4481180, 7KW
Generator hours:	767
Stabilizer system:	Koopnautic fin stabilizers
Bowthruster (Brand, type, elec/hyd):	Koop nautic sidemaster, hyd
Water pressure pump (Brand, model):	Reya, AMFA 88B
Hot water system:	Seaward S1950 G-01, 75L
Macerator pump:	Sealand T12VDC
Trim system:	Bennett trim tab 4809

Electrical system

DC system (V) AC system (V):	12V, 230V
Battery charger (V/W/Amp):	Mastervolt combi 12V 2500W 100AMP
Inverter (V/W/Amp):	Mastervolt combi 12V 2500W 100AMP
House battery (Number of battery,type, total Amp, year):	4x 230 Ah (2019)
Start battery (Number of battery,type, total Amp, year):	2x + 1x generator

Safety system

Life raft:	Plastimo offshore, 6 personen, gekeurd tot 2013
Electrical bilge pump:	3x rule 2000GPH
Manual bilge pump:	1x Whale gusher 10 MK3

Fire extinguisher engine room:	2x
Fire alarm:	2x
Gas detector:	2x
Horn:	kahlenberg

Navigation system

Compass:	Rithcie
Gps plotter:	Simrad NSS8
Radar screen:	Simrad RA42C
Radar :	1x Simrad Broadband 4G 1x Simrad RB716A
Autopilot:	Simrad AP22
Rudder indicator:	VDO
Log:	Simrad IS15
Depth meter:	Simrad IS15
Wind meter :	Simrad
VHF:	Saillor RT4822

Equipment

Tender:	zodiac 310, Yamaha 4 PK
Gangway:	Opacmare
Windlass:	Lofrans Tigres 1000W
Deckwash:	1x
Deck shower:	Achterop











































GB 42 CLASSIC ARRANGEMENT PLAN
42CL#1493 (GRAND BANKS YACHTS, EUROPE)

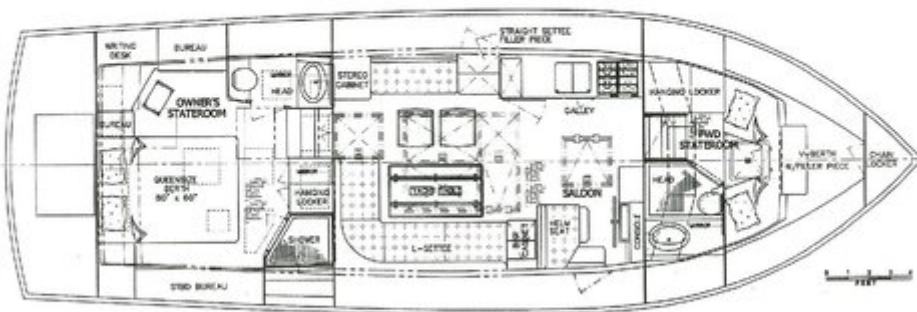

These particulars are given in good faith as supplied but cannot be guaranteed and cannot be used for contracts.